



The VELFAC Ribo  
window system







ALSO FOR NEW BUILD





TRADITIONAL SASH /FRAME DESIGN



BUILD IN SECURITY PACKAGE WITH EXTRA STRONG CLOSING SYSTEM, ENHANCED HINGES AND SCREWS AS WELL AS SAFTY GLUED GLAZING



DANISH DESIGNED ERGONOMIC ESPAGNOLETTE

MATCHING SELECTION OF DOORS. FIND IT ONLINE OR IN THE MAIN CATALOGUE





# VELFAC RIBO ALU – OVERVIEW

## CHARACTERISTICS

With soft, moulded frames, VELFAC Ribo elements can be divided by elegant, slim glazing bars to match existing windows, or to reflect the style or age of your home.

- Security package
- Extensive test program covering burglary resistance, durability, strength and tightness.
- Uw values down to 0,8
- Available with double and triple layer glazing



Sash / frame design for traditional style - new build and replacement.

## OPENING FUNCTIONS AND PERFORMANCE

### OPENING FUNCTIONS

		01 sidehung	07 sideguided	09 sidehung fully reversible	10 fixed light	11 fixed casement	12 topguided	29 tophung fully reversible	31 casement door	35/36 patio door <sup>(2)</sup>	37 sliding door	41/42 glazed entrance door	43/44 flush entrance door
<b>PERFORMANCE</b>	Outward opening	x	x	x			x	x	x	x	x	x	x
	Inward opening									x		x	x
	2-leaf with French casement	x	x						x				
	Handle operated brake	x							x	x			
	Friction brake					x							
	Automatic catch for safe cleaning			x			x						
	Standard restrictor	x <sup>(1)</sup>	x <sup>(1)</sup>	x <sup>(1)</sup>			x <sup>(1)</sup>	x					
	Prepared for external grille									x <sup>(3)</sup>			
	Max. sash weight (kg)	70	60	60	200	200	70	60	90	112	400	112	112

### TYPES OF PANELS

- Sandwich panel
- Ventilated panel

<sup>(1)</sup> option <sup>(2)</sup> with internal and external handles <sup>(3)</sup> option for inward opening



# VELFAC RIBO ALU

## SASH VARIATIONS

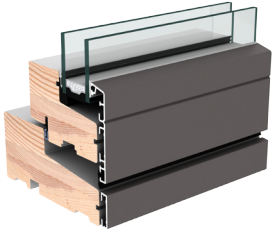

Opening unit – 2 layer glazing

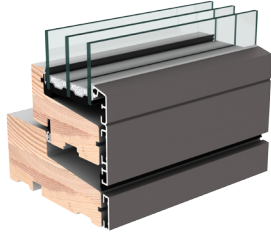

Opening unit – 3 layer glazing

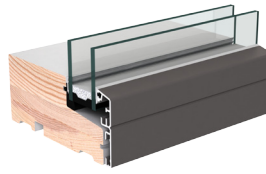

Fixed unit – 2 layer glazing

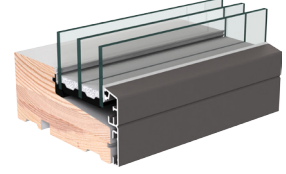

Fixed unit – 3 layer glazing

## GLAZING BARS AND WINDOWS

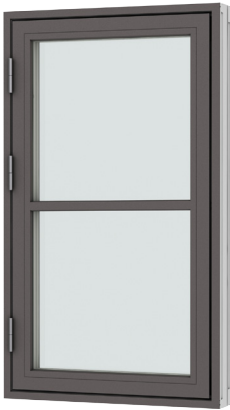

31mm

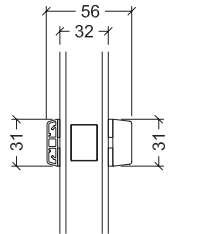

31mm energy glazing bar, 2 layer glazing

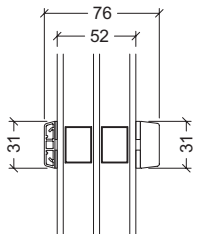

31mm energy glazing bar, 3 layer glazing



68mm

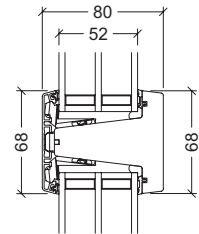

68mm glazing bar, 3 layer glazing

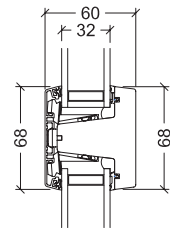

68mm glazing bar, 2 layer glazing



71mm

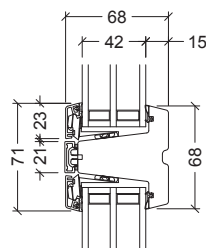

71mm glazing bar for sliding casement door

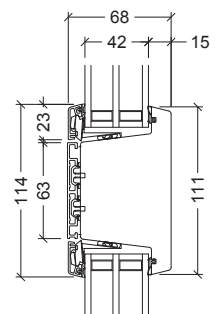

114mm glazing bar for sliding casement door



# VELFAC RIBO ALU – OPENING FUNCTIONS

## SIDEHUNG WINDOW - VELFAC RIBO ALU 01



- The sash opens up to 90°
- Visible hinges
- The espagnolette has a built-in ventilation position and handle operated brake

### Min./max. sizes

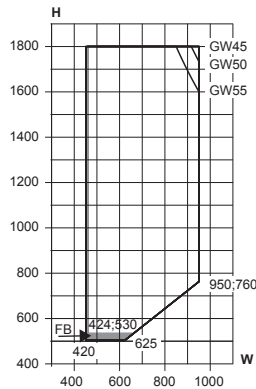

GW = glass weight (see page 16)  
 FB = friction brake and espagnolette without brake

## SIDEGUIDED WINDOW - VELFAC RIBO ALU 07

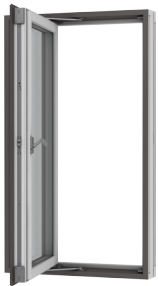

- When opened to 85°, a 15cm (minimum) gap allows cleaning from the inside
- To open, the sash moves on guide rails mounted on the head and cill
- The espagnolette has a built-in ventilation position

### Min./max. sizes

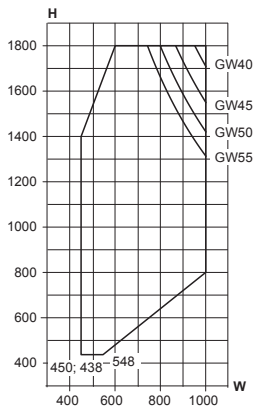



# VELFAC RIBO ALU – OPENING FUNCTIONS

## SIDEHUNG FULLY REVERSIBLE WINDOW - VELFAC RIBO ALU 09



- The sash can be rotated by up to 140-160° to allow cleaning from the inside
- The sash moves in gliding rails installed on head and cill.
- The sidehung fully reversible window can be installed with-drawn up to 200mm from the façade
- The espagnolette has a built-in ventilation position (5mm)

Min./max. sizes

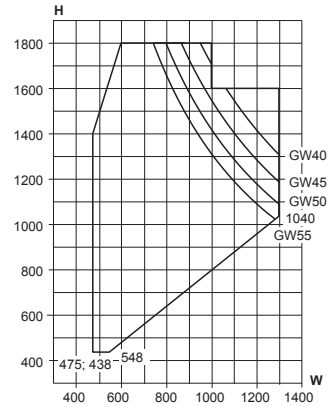

## FIXED LIGHT - VELFAC RIBO ALU 10



- Only as a light source
- Consists only of a frame and is therefore slimmer than the rest of the Ribo alu windows

GW = glass weight (see page xx)

Min./max. sizes

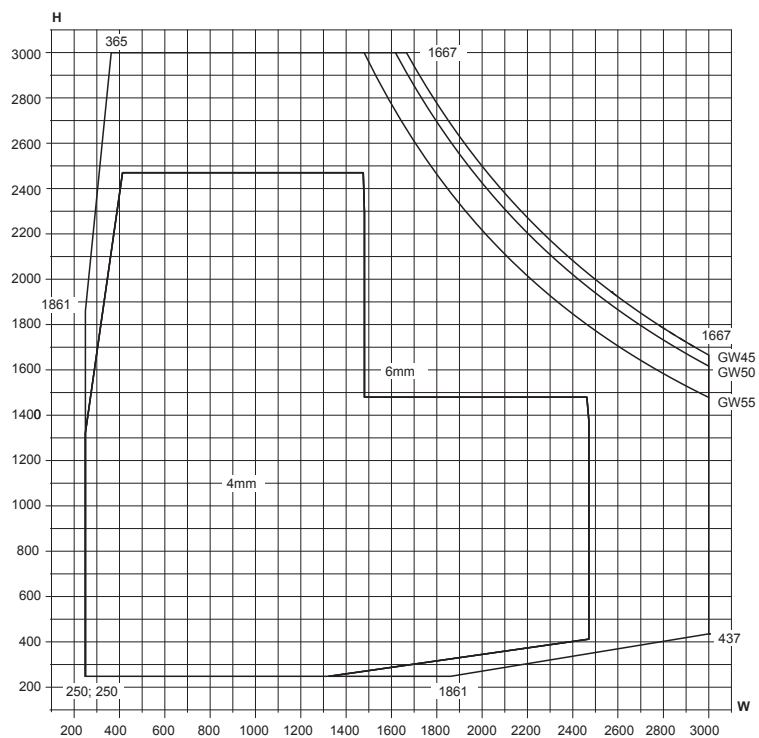



# VELFAC RIBO ALU – OPENING FUNCTIONS

## FIXED CASEMENT - VELFAC RIBO ALU 11



- Only as a light source
- The frame and the sash are integrated. Appears identical to all VELFAC Ribo window types.

Min./max. sizes

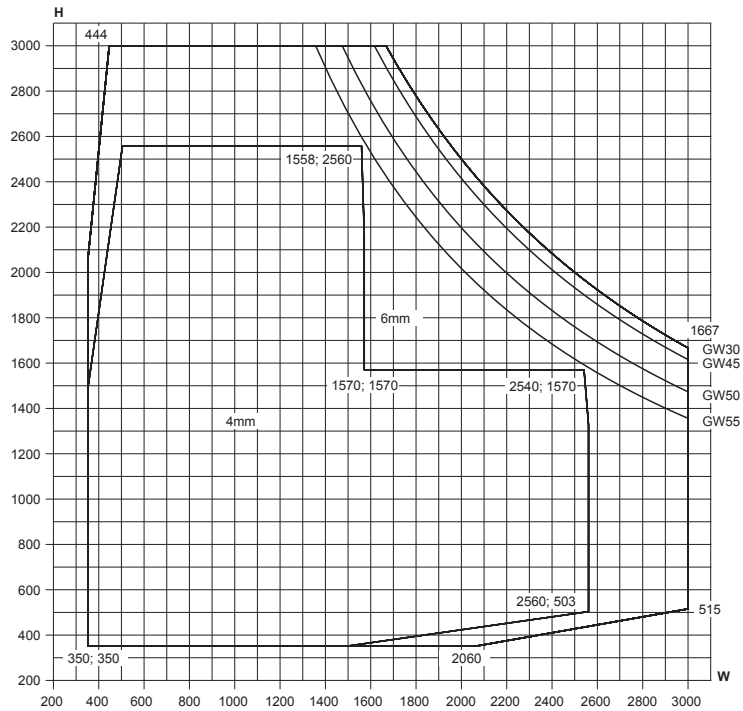

## TOPGUIDED WINDOW - VELFAC RIBO ALU 12



- When opened the sash provides a ventilation gap at the head
- The espagnolette has a built-in ventilation position (5mm)
- An adjustable friction brake can hold the window open in any ventilation position

Min./max. sizes

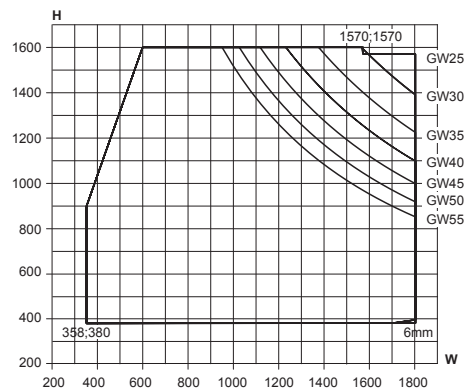

GW = glass weight (see page 16)



# VELFAC RIBO ALU – OPENING FUNCTIONS

## TOPHUNG FULLY REVERSIBLE WINDOW - VELFAC RIBO ALU 29



- The sash can be rotated to allow cleaning from the inside
- Without overlay
- A safety restrictor is triggered when the window is opened approx. 50mm
- Cleaning safety(s) is activated automatically when the frame is turned to the cleaning position (approx. 170°)
- The espagnolette has a built-in ventilation position (5mm)
- The sash has a natural stop before it starts reversing. Here the sash can be held open by the stop

### Min./max. sizes

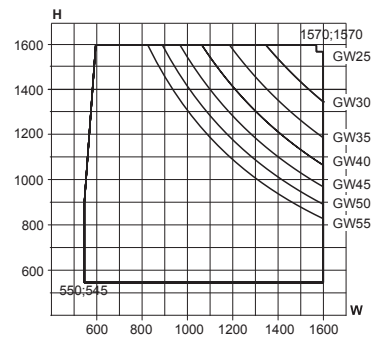

GW = glass weight (see page 16)

## CASEMENT DOOR - VELFAC RIBO ALU 31



- Same frame and sash profile as the windows
- The sash stops at app. 90°. (180° is possible)
- Visible hinges
- 18mm / 22,5mm threshold
- The espagnolette handle has a ventilation position in the striking plate, and a handle operated brake, which can keep the window open in a random position (not possible with 180° hinges)

### Min./max. sizes, 1-leaf

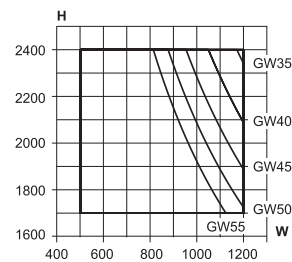

### Min./max. sizes, 2-leaf

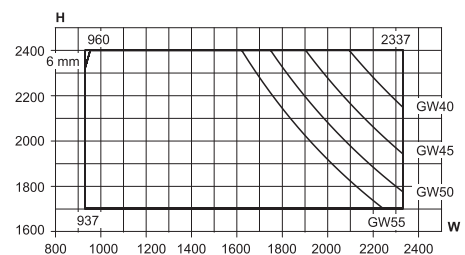

# VELFAC RIBO ALU – OPENING FUNCTIONS

## PATIO DOOR - VELFAC RIBO ALU 35/36



- Available as inward opening (36) or outward opening (35)
- The door is fitted with espagnolette handle externally and internally and lock box for oval cylinder internally
- The sash stops at 90° - optional up to 180° (only outward opening)
- Visible hinges
- 18mm (35) / 22,5mm (36) threshold
- Espagnolette with handle operated brake (not possible with 180° hinges)

### Min./max. sizes

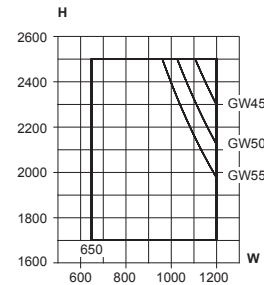

### Min./max. sizes, 2-leaf

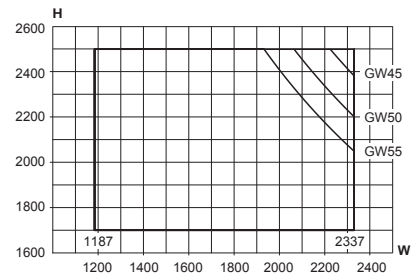

## SLIDING CASEMENT DOOR - VELFAC RIBO ALU 37



- Assures maximum day light intake - only one clamp at the bottom
- When the handle is turned, the sliding door is lifted up so that it can be slid past the fixed part of the element.
- 25mm threshold
- Symmetrical, so the fixed and the moving part are same width
- Free opening up to 1.5m in width
- Only available with tripple layer glazing and wood/alu construction
- The sliding door is fitted with handle internally and finger grip handle externally
- Can be fitted with handle with lock internally and externally.

### Min./max. sizes

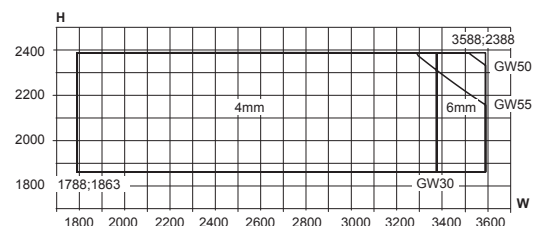

GW = glass weight (see page 16)



# VELFAC RIBO ALU – FRAMES

## WINDOWS AND CASEMENT DOORS (TYPE 31)

## EXAMPLE - 2 LAYER

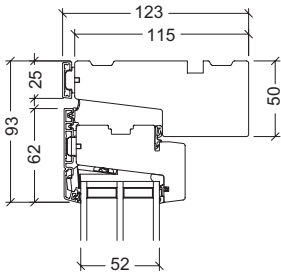

Head, standard

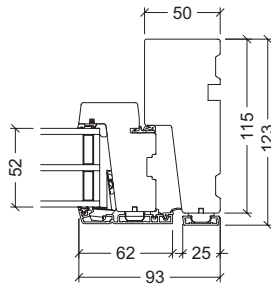

Jamb, standard

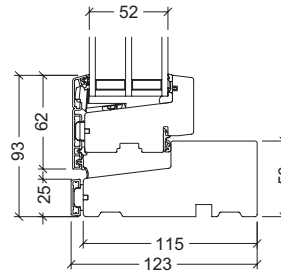

Cill, standard

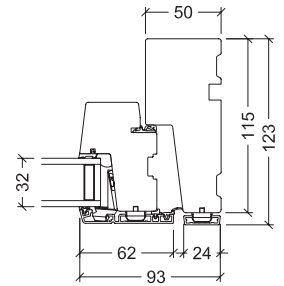

Standard jamb with 28 mm glazing

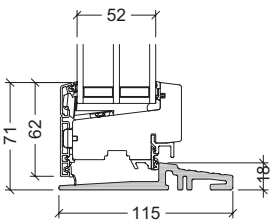

18mm HELO® threshold, casement door  
Note: 22.5mm with 148mm frame

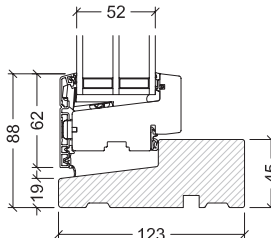

45mm hardwood threshold, casement door

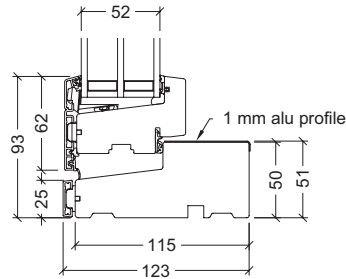

50mm threshold with aluminium treadplate, casement door

## PATIO DOORS (TYPE 35/36)

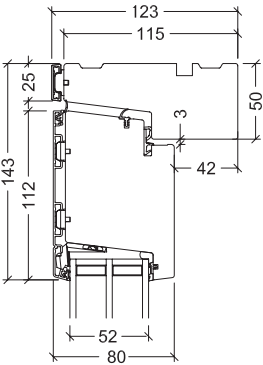

Head, outward opening door

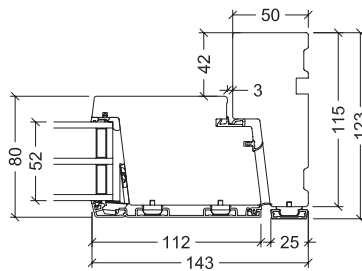

Jamb, outward opening door

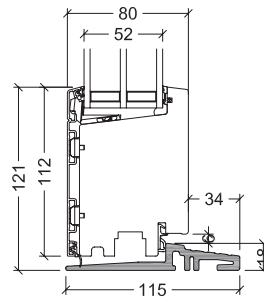

18mm HELO® threshold, outward opening door  
Note: 22.5mm with 148mm frame

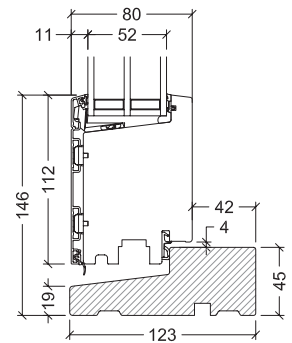

45mm hardwood threshold, outward opening door

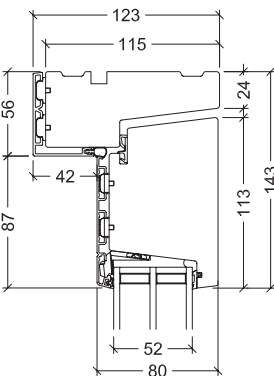

Head, inward opening door

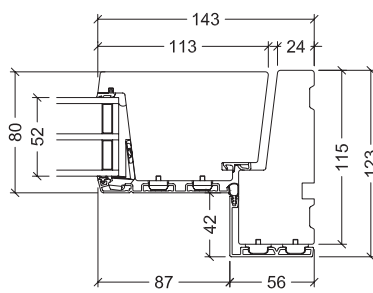

Jamb, inward opening door

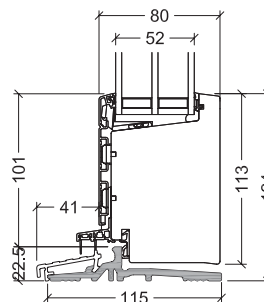

22.5mm HELO® threshold, inward opening door

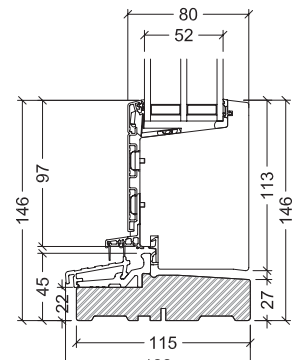

45mm hardwood threshold, inward opening door

# VELFAC RIBO ALU – FRAMES AND FRAME VARIATIONS

## FIXED CASEMENT

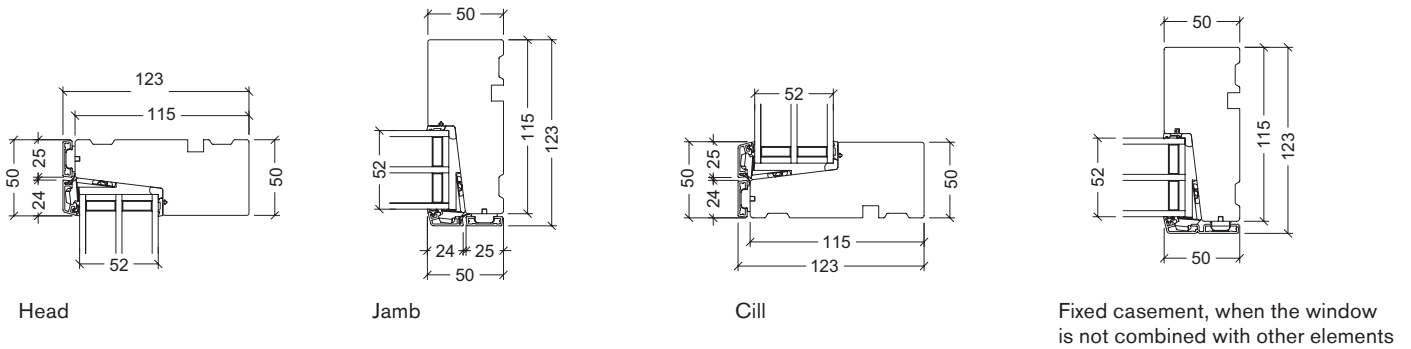

## SLIDING CASEMENT DOOR

Available as wood/aluminium element and 3-layer glazing only

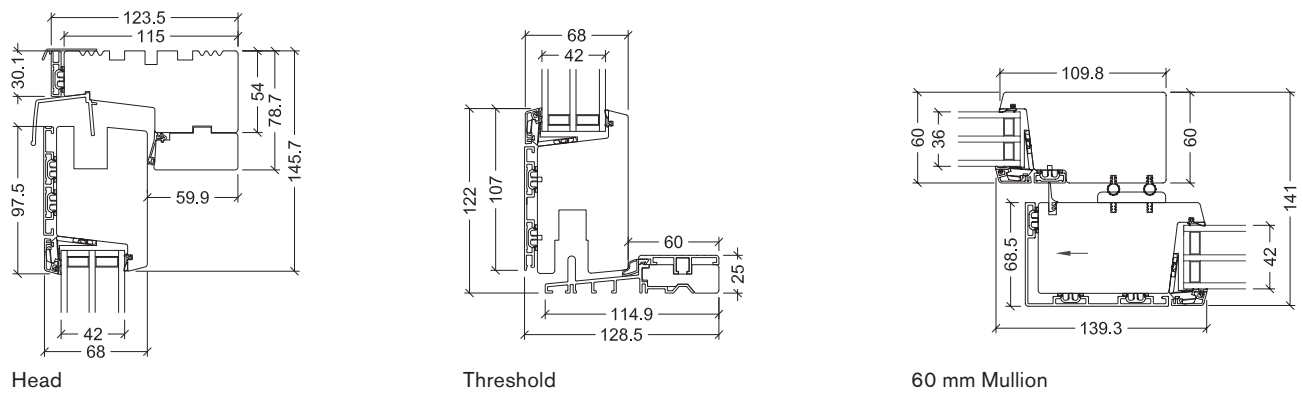

## FRAME VARIANTS

Outward opening elements

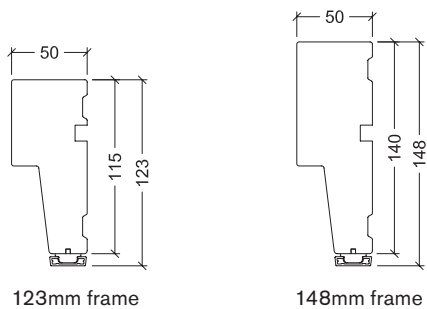

Inward opening patio doors

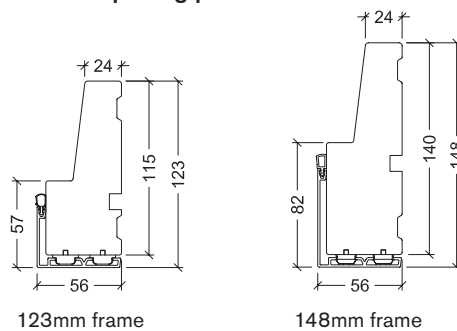



# VELFAC RIBO ALU – MULLIONS AND TRANSOMS

## MULLIONS AND TRANSOMS FOR WINDOWS AND CASEMENT DOORS

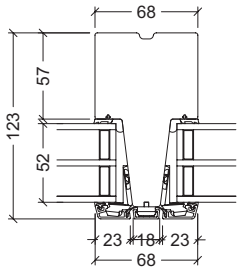

Mullion, fixed casements

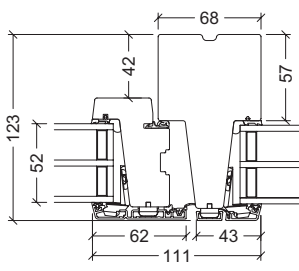

Combination mullion

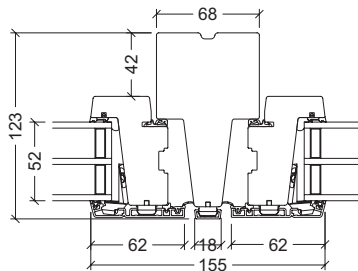

Mullion, standard and French casement

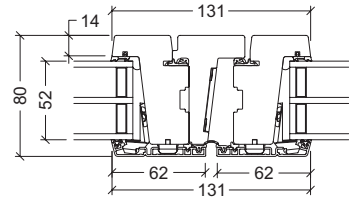

Rebated meeting style

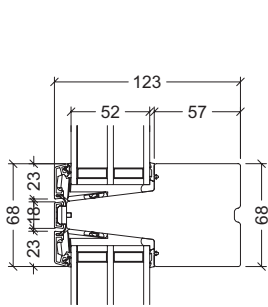

Transom, fixed casement

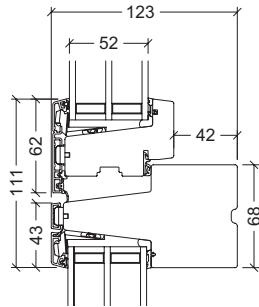

Combination transom

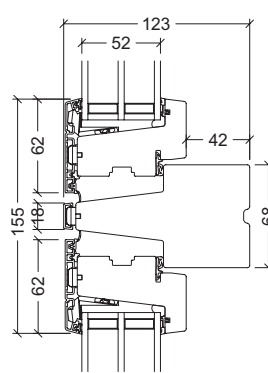

Transom, standard

## MULLIONS AND TRANSOMS FOR PATIO DOORS (35/36)

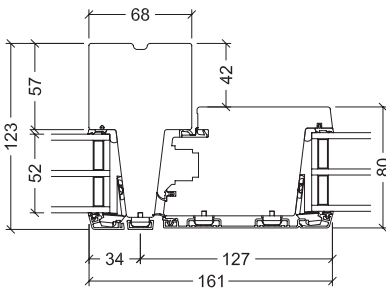

Transom (mullion), fixed side light, outward opening patio door.

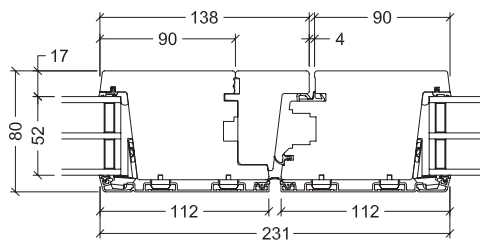

Mullion, French casement, outward opening patio door

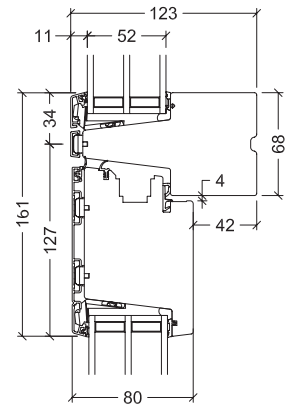

Fixed toplight, outward opening patio door

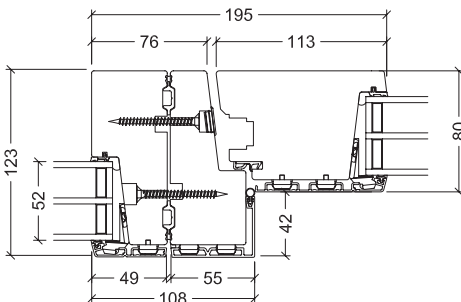

Transom (mullion), fixed side light, inward opening patio door.

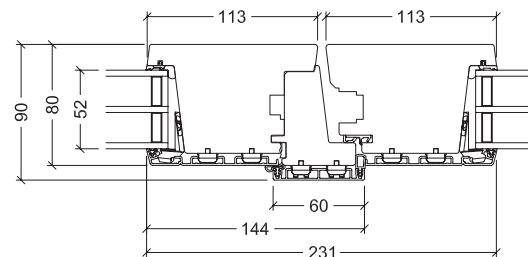

Mullion, French casement, inward opening patio door

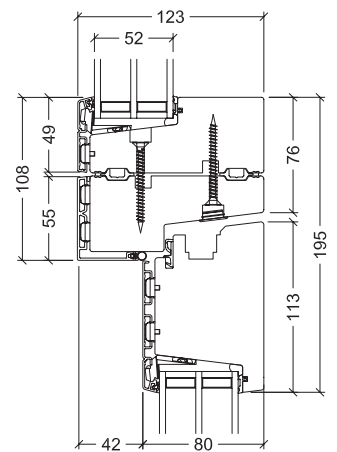

Fixed toplight, inward opening patio door

# VELFAC RIBO ALU – FRAME OPTIONS + ACCESSORIES

## GROOVES, REBATES AND PACKERS

Please note that the grooves, rebates and packers are shown in 115mm (123mm), but are also available with the window system's other frame variations.

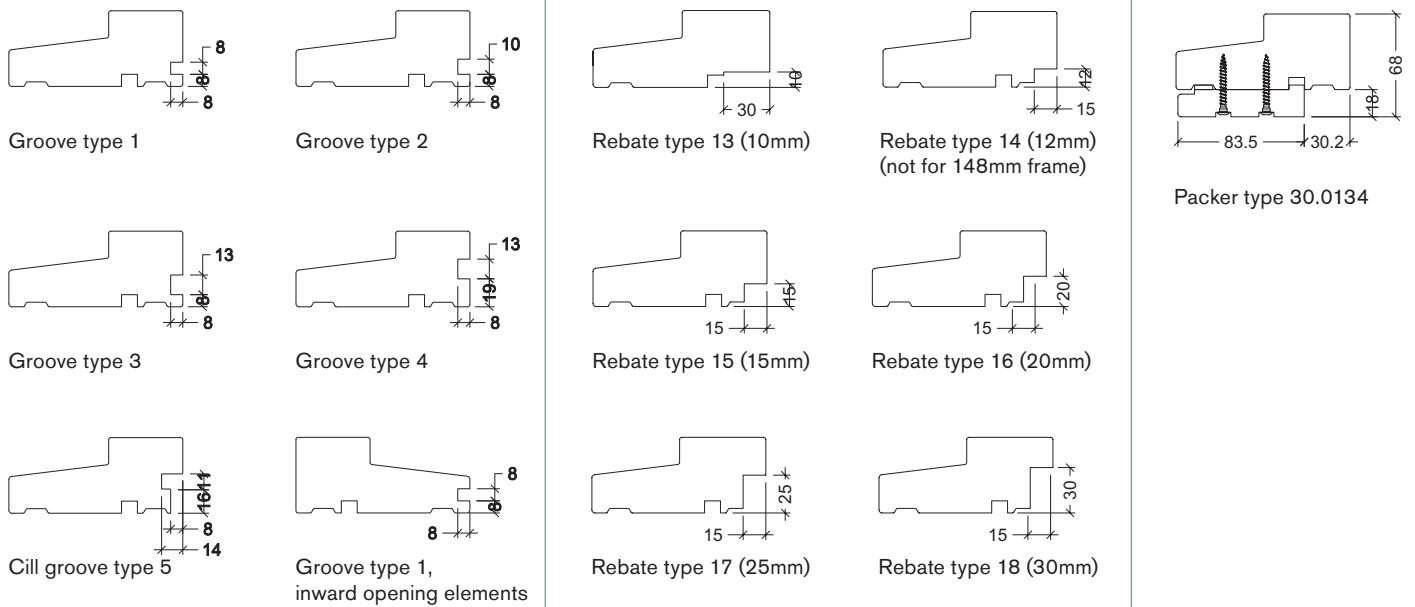

## ESPAÑOLETES, SECURITY FITTINGS AND ACCESSORIES

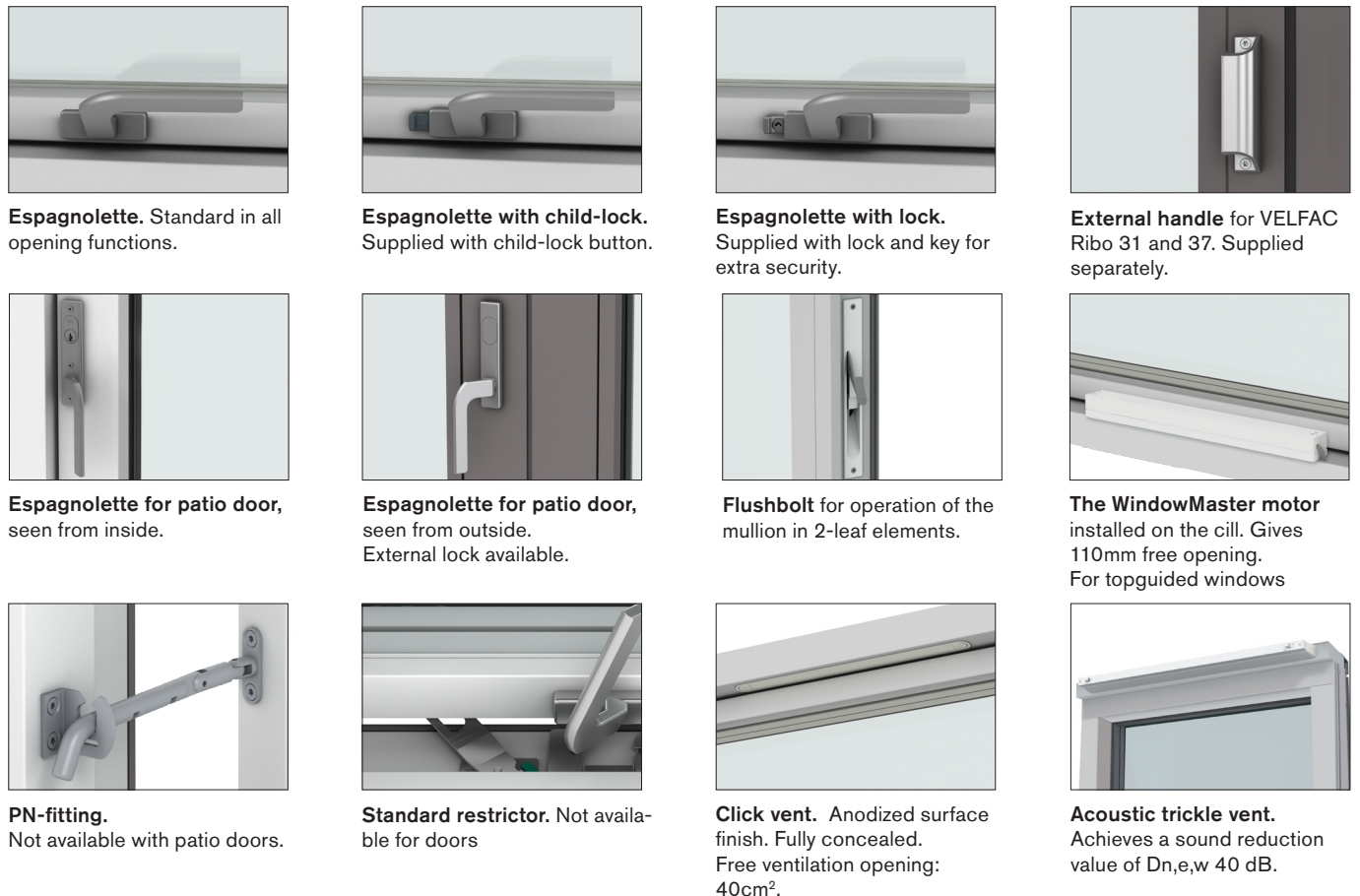



# VELFAC RIBO ALU - COLOURS AND GLAZING

## COLOURS

VELFAC Ribo aluminium clad timber windows are available with the external aluminium sash powder-coated in all standard RAL colours or one of 6 Granite colours and the wood frame painted externally and internally in one of 6 RAL colours.



All standard RAL colours



Anodised in silver or bronze

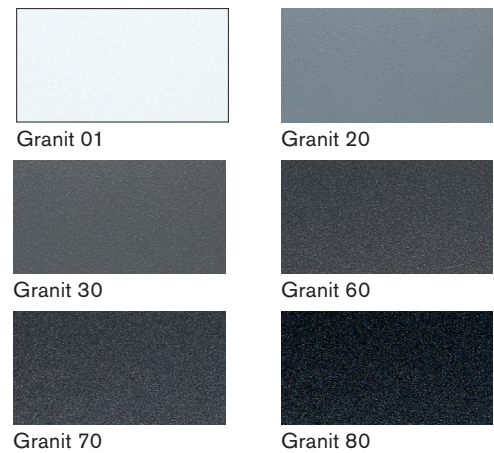

**N.B.** The colours shown here are only guidelines. Please ask to see regular colour samples before placing your order.

## CALCULATION OF GLASS WEIGHT

All window glass, including any laminating material, has a weight of 2.5 kg per square metre, per millimetre thickness. The weight of the spacer profile is unimportant and therefore not measured.

Glazing	Calculation of glass weight (GW)		
4-16-4	= (4+4) x 2.5 kg	= 20 kg/m <sup>2</sup>	= GW 20
6-14-4	= (6+4) x 2.5 kg	= 25 kg/m <sup>2</sup>	= GW 25
3/0.38/3-14-4	= (6.38+4) x 2.5 kg	= 26 kg/m <sup>2</sup>	= GW 26
6-12-6	= (6+6) x 2.5 kg	= 30 kg/m <sup>2</sup>	= GW 30
4-18-4-18-4	= (4+4+4) x 2.5 kg	= 30 kg/m <sup>2</sup>	= GW 30
8-8-4/0.38/4	= (8+8) x 2.5 kg	= 40 kg/m <sup>2</sup>	= GW 40
4/0.76/4-16-6-14-4/0.38/4	= (8+6+8) x 2.5 kg	= 55 kg/m <sup>2</sup>	= GW 55

## WINDOW TERMINOLOGY

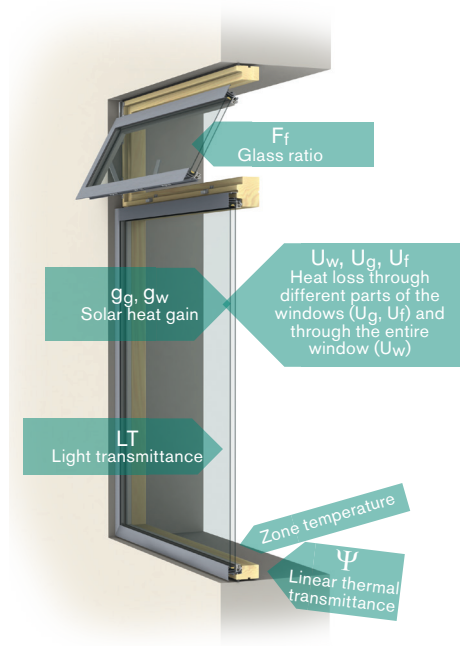





Secured by Design



Official Police Security Initiative



The Wood Window Alliance



The mark of responsible forestry  
FSC® C101947

Please ask for our FSC®-certified products.

VELFAC IRELAND Ltd.

E: [irishestimating@velfac.ie](mailto:irishestimating@velfac.ie)

E: [aftersales@velfac.ie](mailto:aftersales@velfac.ie)

W: [www.VELFAC.ie](http://www.VELFAC.ie)



WINDOWS FOR LIFE

03 201 06 16 © 2016 VELFAC IRELAND Ltd. ® VELFAC and VELFAC logo are registered trademarks used under license by Vel. The information contained in this catalogue is correct at time of print. However, due to our commitment for continuous product development, the product details may change without notice. All rights reserved.



energy | design | quality | consultancy